

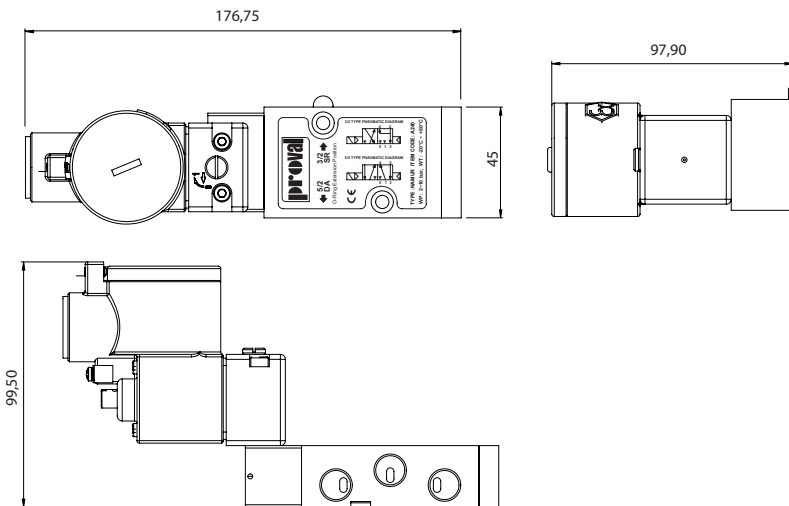

A240CX-BD/CD/DD Flameproof Coil Solenoid Valves Ex db IIC T6 Gb

A240X-BD/CD/DD type 3/2 way and 5/2 way solenoid valves with namur interface configuration are interchangeable for use on either double or single acting pneumatic actuators in potentially explosive environments. CNOMO based flameproof coils are available with M20x1,5 or 1/2" NPT threaded connection for use with standard or armoured cable glands (supplied optionally)



Technical Specifications;

| Type of Protection | Ex d | Ex ia |
|-----------------------|--------------------------------------|--|
| Solenoid Valve Type | NAMUR | |
| Power Supply | 24VDC / 230VAC | 24VDC - 1.6W |
| Function | 3/2 or 5/2 | |
| Working Pressure | 2-10 bar | |
| Air Supply | G1/4" / NPT 1/4" | |
| Electrical Connection | M20x1,5 / 1/2" NPT | |
| Supply Specifications | 24VDC 3,5W 220 VAC 4VA (50/60 Hz) | Min: Ui:16V li:25mA Pi: 0.4W Max: Ui:26V li:146mA Pi: 949mW |
| Working Temperature | -20 °C ~ + 60 °C | |
| Flow Capacity | 720 Lt/min | |
| ATEX Certificate | Ex II 2G Ex db IIC T6 Gb | Ex II 2G Ex ia IIC T6 Ga Ex II 2D Ex ia IIIC T85 °C Db |

A244CX-BD/CD/DD Flameproof Dual Coil Solenoid Valves Ex db IIC T6 Gb

A244CX Series valves are suitable for NAMUR interface pneumatic actuators for use in potentially explosive areas, spring return to middle position, with manual override, centre closed with flameproof ATEX coils. CNOMO based flameproof coils are available with M20x1,5 or 1/2" NPT threaded connection for use with standard or armoured cable glands (supplied optionally)

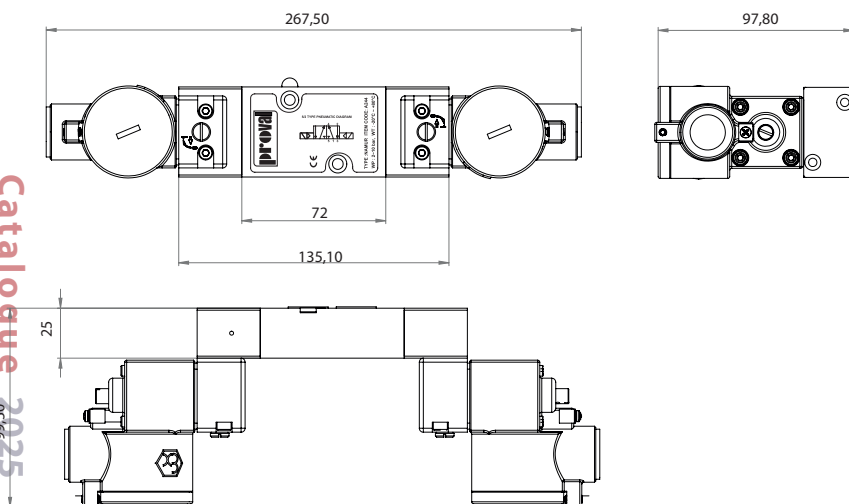
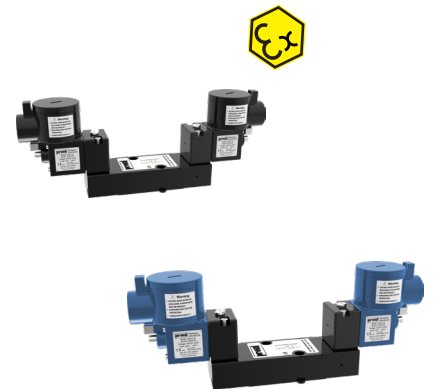

Technical Specifications;

| Type of Protection | Ex d | Ex ia |
|-----------------------|--------------------------------------|--|
| Solenoid Valve Type | NAMUR | |
| Power Supply | 24VDC / 230VAC | 24VDC - 1.6W |
| Function | 5/2 or 5/3 (Closed Center) | |
| Working Pressure | 2-10 bar | |
| Air Supply | G1/4" / NPT 1/4" | |
| Supply Specifications | 24VDC 3,5W 220 VAC 4VA (50/60 Hz) | Min: Ui:16V li:25mA Pi: 0.4W Max: Ui:26V li:146mA Pi: 949mW |
| Working Temperature | -20 °C ~ + 60 °C | |
| Flow Capacity | 720 Lt/min | |
| ATEX Certificate | Ex II 2G Ex db IIC T6 Gb | Ex II 2G Ex ia IIC T6 Ga Ex II 2D Ex ia IIIC T85 °C Db |