

A280 Series Manual Override Gearboxes Installation & Operation Manual

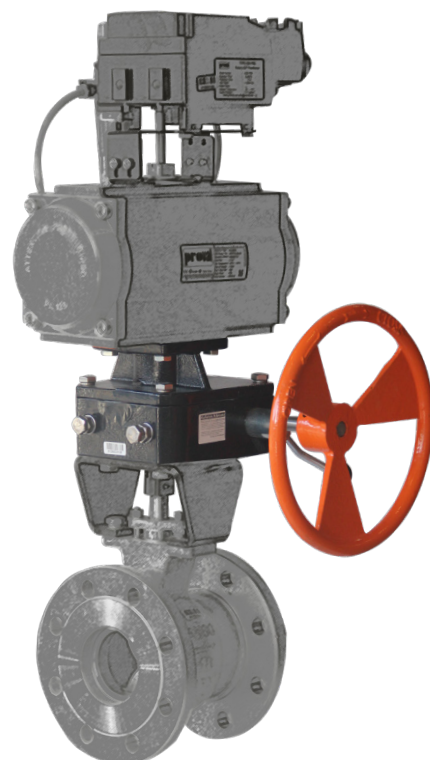
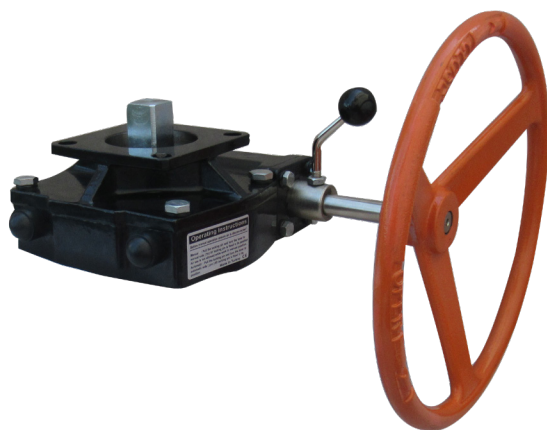

Product Description

PROVAL A280 Series manual override gearboxes are ruggedly designed and produced for users of all industries requiring reliable manual operation of actuated valves at emergency situation.

Manual override gearboxes employ a declutchable worm and worm wheel mechanism for manually overriding the pneumatic and hydraulic valve actuators in process applications.

A280 Series declutchable gear operator series features:

- Compact, lightweight
- Integral ISO 5211 mounting flange for easy and cost-effective actuator assembly
- Double Square connection according to ISO 5211
- Wide torque range from 300 Nm to 15000 Nm
- Engagement / Disengagement effected by pulling and turning the position pin 180°
- Made of Cast Iron with epoxy powder coating
- Suitable for both Double-Acting and Spring-Return applications



ATTENTION

Manual override gearboxes are used in case of air failure. Before operation, disconnect and discharge the air supply to actuators by Proval A75 series block & bleed valves. If block & bleed valve is not used, disconnect the air supply tubes. Air should not be supplied to actuators in any case while the gearbox is in manual mode !

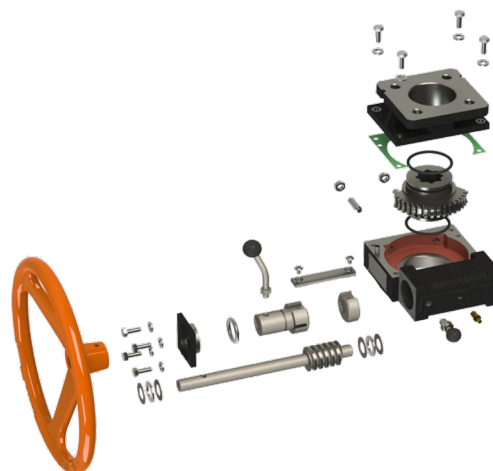

Operation,

Manual Mode - Engaging the Gear,

1. Ensure air is disconnected & discharged from actuator
2. Pull the locking pin
3. Turn the control lever by 180° counter clockwise, at the same time slightly turn the hand wheel until the locking pin completely re-engages and control lever reaches the manual mode.

Auto Mode – Disengaging the Gear,

1. Pull the Locking pin
2. Turn the control lever by 180° clockwise, at the same time slightly turn the hand wheel until the locking pin completely re-engages and control lever reaches the auto mode.
3. De-energize the block & bleed valves (or connect the air tubes) for enabling the air supply to actuators

